

FIREBREAK SASH SHUTTER WITH: PNEUMATIC CLOSING: Code STFRPCMT

CERTIFIED WITH NORM EN1366-2 EN13501-3 CSI1646FR REI120-RE120

IMPORTANT CHARACTERISTIC FOR THE CHOICE OF FIREBREAK SASH SHUTTER

The particular merit of this type of shutter is to allow the passage in the complete section of the piping which is sets, being the diaphragm of closing in open position out of the section of the piping. This main point permits to the diaphragm is to be always entire in the time.

Every shutter is equipped with certificate of conformity and instructions of use.

The inferior side is openable to allow the emission of probable materials that where deposited during the job.

Application: in walls Only installation with fitline in depression

Assembly system:
 Mod: STFRPCMT in all position (only horizontal piping)

Building material:
 Galvanized steel until Ø 750 body thickness 30/10, pipe unions 20/10,
 from Ø 800 body thickness 40/10, pipe unions 30/10
 Electric micro switch or on off magnetic switch on request

METHOD OF OPERATING

STFRPCMT: with opening and closing by ISO cylinder and electric valve with system connection by signal or survey sparkles (automatic rearmament): on request possibility of control's system electric valve with fuse and micro-switch.



TECHNICAL DATA

Ø mm	A	B	C	D	Kg.
Ø 200	830	555	335	605	48
Ø 250	980	605	335	730	55
Ø 300	1030	655	335	755	60
Ø 350	1180	705	335	880	68
Ø 400	1230	769	335	905	75
Ø 450	1480	819	335	1130	88
Ø 500	1530	900	335	1155	95
Ø 550	1680	950	335	1280	110
Ø 600	1730	1021	335	1305	130
Ø 650	1880	1071	335	1430	150
Ø 700	1930	1121	335	1455	180
Ø 750	2080	1171	335	1580	205
Ø 800	2215	1206	540	1620	230
Ø 850	2365	1256	540	1745	255
Ø 900	2415	1306	540	1770	285
Ø 950	2565	1356	540	1895	305
Ø 1000	2615	1420	540	1920	320
Ø 1050	2765	1470	540	2045	345
Ø 1100	2815	1520	540	2070	370
Ø 1150	2965	1570	540	2195	395
Ø 1200	3015	1620	540	2220	420

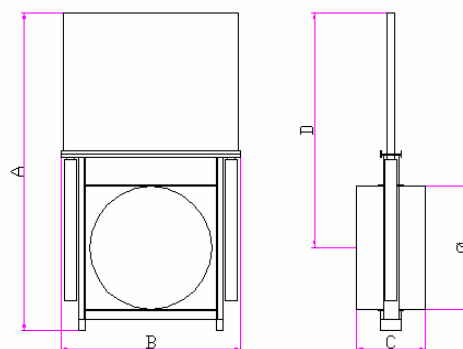

Important: the dimension of pipe line's section of feeling air has to be the same or superior to the electric valves dimensions and pressure work minimum 6 bar.

	Ø200 ÷ Ø480	Ø500 ÷ Ø750	Ø800 ÷ Ø1000	Ø1050 ÷ Ø1200
Closing time "seconds"	2"	3"	4"	4"
Applied electro-valve or to apply	¼"	¼"	½"	½"
Air hose mm	Ø8x2000	Ø10x2000	Ø12x2000	Ø14x2000